

The University of Sydney

sydney.edu.au



Contact us

sydney.edu.au/law
+61 2 9351 0351

Postgraduate guide 2018

Law



We are one
of the world's
leading
law schools,
ranked 13th
in the world.*

Forest Stewardship Council (FSC®) is a globally recognised certification overseeing all fibre sourcing standards. This provides guarantees for the consumer that products are made of woodchips from well-managed forests and other controlled sources with strict environmental, economical and social standards.



*2017 QS World University Rankings
by Subject (for Law)

Postgraduate guide 2018

Law

Contact us

sydney.edu.au/law
+61 2 9351 0351



Where will postgraduate study lead you?	2
Plan your career	4
Our program at Sydney Law School	5
Meet our staff	7
Offshore opportunities	8
Master of Laws	10
Master of Business Law	14
Master of Taxation	15
Master of International Law	16
Master of Health Law	17
Master of Environmental Law	18
Master of Administrative Law and Policy	19
Master of Criminology	20
Master of Jurisprudence	21
Master of Labour Law and Relations	22
Continuing professional development	23
Research	24
Our research programs in law	25
Research experience in law	26
Centres and institutes	28
How to apply	30
Fees and costs	32
Important dates	33

Where will postgraduate study lead you?

Whether you want to change your career direction or pursue a personal ambition, the University of Sydney will steer you to places you never imagined.

With more than 450 courses on offer, we make it easy for you to tailor a degree to your needs – short or long-term study.

Our coursework and research degrees offer far more than knowledge. You'll join leading thinkers to challenge the known and explore the unknown, in a stimulating environment that encourages both learning and networking. To support research and teaching excellence, we are investing in the latest innovative technology and exceptional facilities.

The University's people drive our greatest feats. We give you access to leading lecturers, research supervisors, industry networks, research and teaching centre staff from Australia and worldwide – across many disciplines.

Our graduates are among the world's most sought-after employees – we are ranked first in Australia and fourth in the world for graduate employability.* The University's regular ranking in the top 50 universities worldwide reflects our outstanding reputation.**

Why study law with us?

The University of Sydney Law School is one of the world's leading law schools. We are ranked 13 in the most recent QS World University Rankings for the discipline of law. With more than 150 years' experience, Sydney Law School is committed to providing you with excellence in legal education.

Legal leadership

A University of Sydney law degree is a challenge that will bring out the best in you. As a Sydney law graduate you will be ready to take on leadership roles in many fields, both within the legal profession and in other contexts. With degrees for both law graduates and those without a law degree, we offer you the opportunity to acquire or extend specialist legal knowledge and skills.

Research excellence

Sydney Law School is an international leader in legal research, led by globally recognised legal educators, world-renowned researchers and highly respected professional practitioners. Our research is world class: Sydney Law School received the highest possible rating of five in the latest Australian Research Council Excellence for Research in Australia (ERA) outcomes reports. We emphasise international and comparative law while also maintaining a strong focus on taxation, commercial, corporate and criminal law. We offer expertise in specialist areas such as climate and environmental law, and health and medical law.

Industry relevance

Sydney Law School offers one of Australia's largest and most specialised coursework programs in law, with 80 percent of units offered on an intensive basis (see page 10). The coursework program reflects the latest developments within the practice and profession of law, and you can experience instruction from domestic practitioners, international visitors and our own academic leaders.

*QS Graduate Employability Rankings 2017

**QS World University Rankings 2018

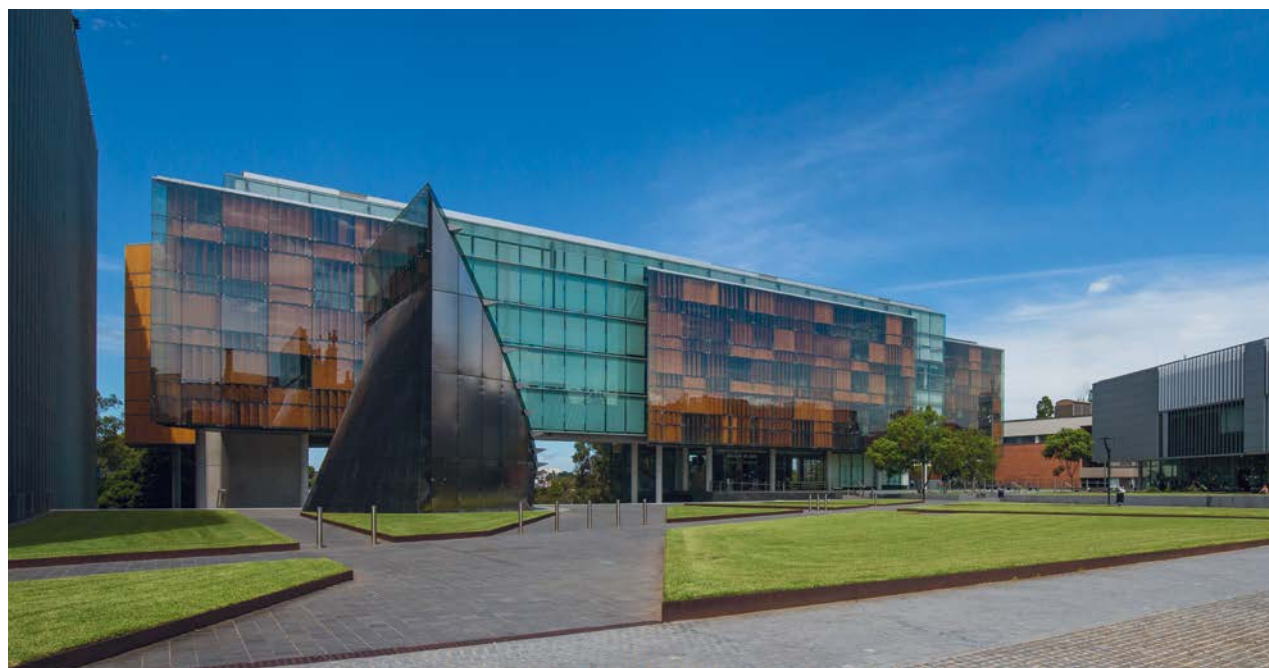

Alumni impact

Our degrees can take you anywhere. Our alumni can be found in legal and non-legal roles around the world. We have a reputation for excellence and innovation built on more than 150 years of teaching and researching law – a reputation that opens doors. At Sydney Law School, we have produced six prime ministers of Australia, three of the five women Justices of the High Court of Australia, and we were the first Australian law school to admit women.

International engagement

We are part of a highly regarded group of international law schools that includes Oxford and Cambridge in the United Kingdom and Tsinghua University in China. You will have an invaluable opportunity to gain international experience and translate the skills and knowledge you learn at Sydney into an international career.

Scholarships

Sydney Law School offers a number of generous scholarships designed to recognise potential, assist those in need, reward high achievement and support future success.

Scholarship	Who is eligible	Basis for award	Tenure	Total value of award
Ross Waite Parsons Postgraduate Coursework Law Scholarship	Commencing master's students	Merit	Up to two years	\$10,000
John O'Brien Memorial Coursework Scholarships in Criminal Law and Criminology	Commencing Master of Criminology students	Merit	Up to two years	\$6000
Victoria Gollan Memorial Scholarship	Aboriginal and Torres Strait Islander students	Access and merit	One year	\$1500
Justice Peter Hely Scholarship	Law graduates, graduands or final-year students considering a master's degree	Merit	One year	\$20,000
Reca Stone Scholarship in Legal Theory	Commencing and continuing students	Merit and financial need	One year	\$10,000
The Walter Reid Scholarship	Continuing students	Overseas research	One year	\$7000
W A Cooke, Jane Cooke and Alfred Godfrey Postgraduate Research Law Scholarships	Commencing and continuing PhD students	Merit	3.5 years	\$35,000
Julian Small Research Scholarship in Labour Law	Commencing and continuing students	Merit	1.5/3.5 years	\$87,500 (PhD)/ \$37,500 (LLM)

For more information, visit: sydney.edu.au/law/scholarships

Plan your career

Here are a few examples of the postgraduate study options available at Sydney Law School. Our specialist coursework degrees are open to graduates from any discipline, while our Master of Laws is open to law graduates only.

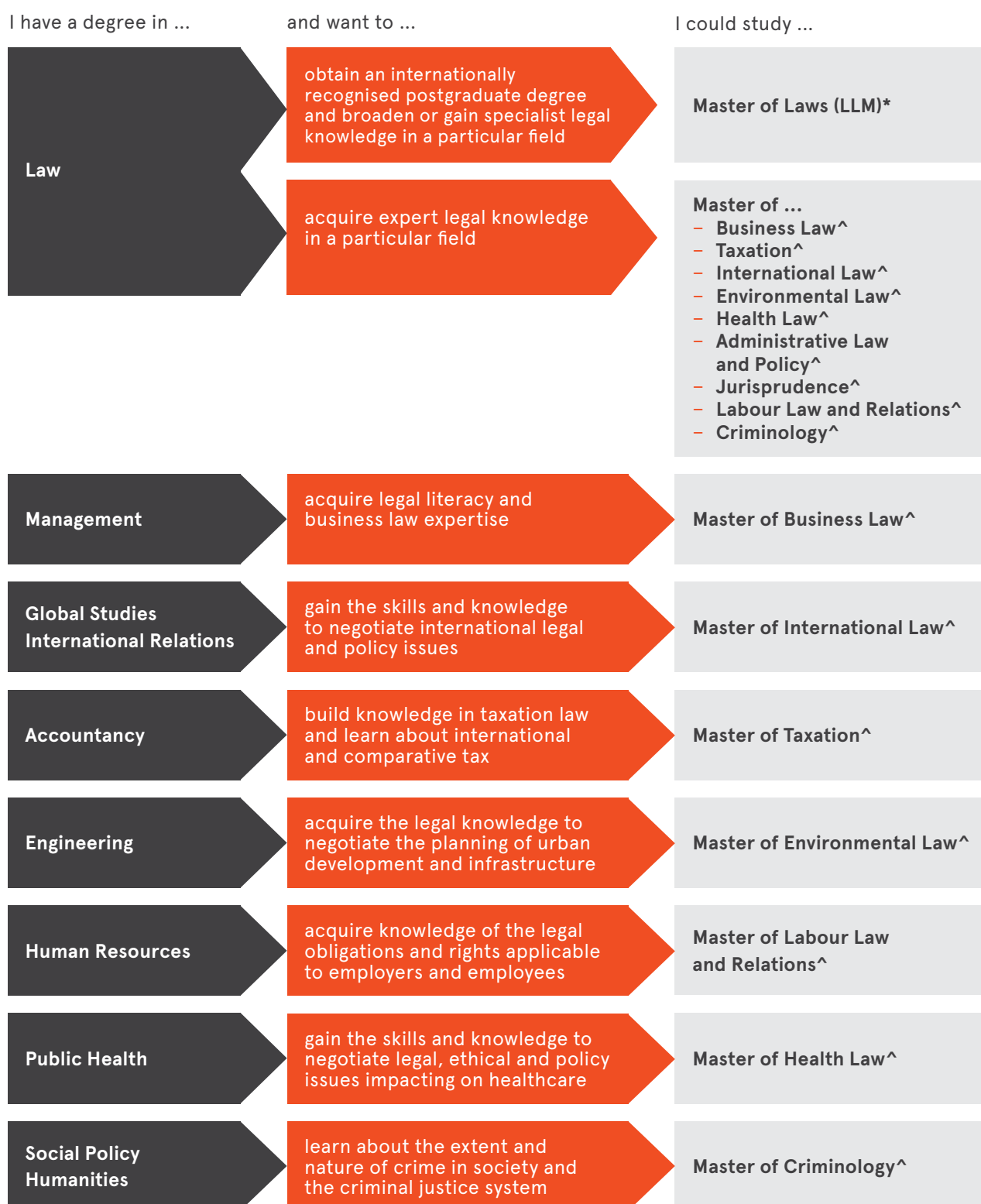

* this degree is open to law graduates only

^ this degree is open to graduates from any discipline

Our program at Sydney Law School

Our postgraduate coursework programs are highly regarded and provide those students who have a legal background with specialist legal training. If you are from a non-legal background you can acquire the legal knowledge needed to succeed in your current profession.

The Master of Laws (LLM) is our flagship postgraduate degree and provides lawyers with expert in-depth specialist legal knowledge. Students can choose from the entire range of postgraduate coursework units of study offered in any given year by Sydney Law School. This gives you the opportunity to tailor the program to suit your needs.

You may select all eight units of study required to complete the degree in one area such as International Law or Corporate, Securities and Finance Law. Alternatively, you may like to combine fields of study by selecting units in Commercial Law alongside those in Environmental Law, for example.

We also offer specialist coursework degrees in Administrative Law, Business Law, Criminology, Environmental Law, Health Law, International Law, Jurisprudence, Labour Law and Taxation Law for those with or without a legal background.

We offer a huge variety of units of study, most of which are taught intensively. This allows you to manage your study with your professional and personal circumstances. As a lawyer, you will have the opportunity to share classes with non-lawyers and experience a dynamic and interactive study environment.

Research themes

You can pursue your interests across 21 specialist research themes. To find out more, see page 25.

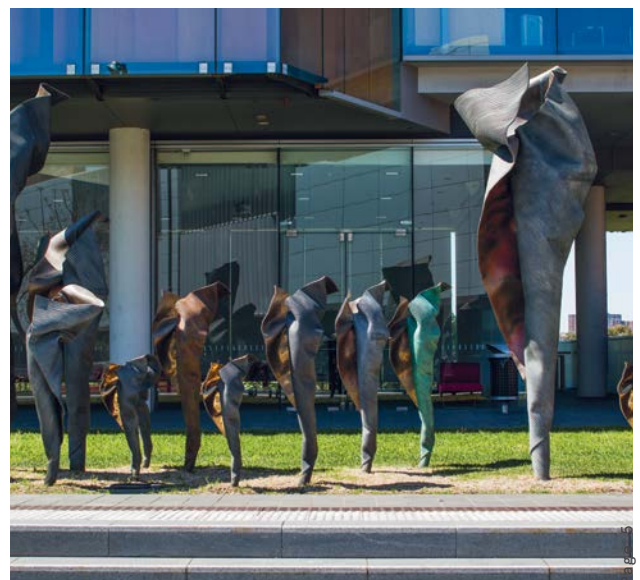

Postgraduate coursework options

Master's degrees

These are ideal if you need specialised knowledge and skills, and want to:

- take the next step in your career
- gain professional qualifications for your next job
- upskill for your current role
- develop academic expertise in your chosen field
- expand your horizons.

They typically require one year of full-time study. If you can't commit to a full-time master's degree straight away because of, say, family or work commitments, we also offer the flexibility of part-time study for domestic students.

Graduate diplomas

Graduate diplomas are an alternative worth considering if you want to try out postgraduate study, increase the breadth of your expertise and knowledge, or you don't quite meet the entry requirements for a master's degree.

Once you finish the graduate diploma, you may be able to progress to a master's degree – please note that progression requirements can vary.

A graduate diploma is also an excellent option if you don't want to commit to a full master's but still need a solid grounding in your chosen field. Find out more about your course at

- sydney.edu.au/courses

*Please note that the University of Sydney Law School does not offer graduate certificates.

Units of study

For a list of the units of study offered and the timetable showing when they will be taught, please visit:

- sydney.edu.au/courses

Credit for previous studies

You may be eligible for credit if we assess your previous postgraduate studies as being directly equivalent to our units of study.

How do I apply for credit?

You need to apply when completing your online course application. We will let you know in your offer letter if you have been successful.

For more information, visit

- sydney.edu.au/study/credit

To view the Sydney Law School Handbook, visit

- sydney.edu.au/handbooks/law/



Meet our staff



“Much of the history of corporate law has concerned itself not with shareholder power, but rather with its absence. Recent shifts in capital market structure require a reassessment of the role and power of shareholders.”

Professor Jennifer Hill
Corporate, securities and finance law



“Intellectual property laws now impact on our daily lives in much more obvious ways than in the past and affect the way we access or engage with technology, medicine, nature, education and entertainment.”

Professor Kimberlee Weatherall
Intellectual property



“We should try harder to acknowledge our cultural blindspots, to see the suffering of others and to act for all of humanity in peril. Global justice demands it.”

Professor Ben Saul
Counter-terrorism law



“There is tremendous, untapped potential to use law more effectively to strengthen health systems and change lives for the better. The law is a powerful tool to help people live longer and healthier lives, and for economies to be more resilient.”

Professor Roger Magnusson
Public health law

For our complete list, please visit:

– sydney.edu.au/law/about/staff/academic.shtml

Offshore opportunities

Experience overseas study through one of our offshore programs.

Himalayan Field School

Are you interested in the law and politics of development and human rights in developing countries? Would you like to see first hand how international law assists poor and vulnerable communities overseas, including refugees and minority groups? Have you ever wondered what it would be like to work for a United Nations agency in the field?

The Sydney Centre for International Law offers the Himalayan Field School, an elective unit of study conducted over two weeks in Nepal that explores the fascinating and difficult challenges of development and human rights in this region.

The unit can be credited towards your postgraduate degree at Sydney Law School. It exposes you to the role and limits of law in addressing acute problems such as socioeconomic development and human rights faced by developing countries such as Nepal.

For more information, visit:

- sydney.edu.au/law/offshore/himalayan_fieldschool

Kyoto and Tokyo seminars in Japanese law

The Kyoto and Tokyo seminars in Japanese law offer a unique opportunity to undertake intensive study of Japanese law within its geographic and socioeconomic context.

The aim of this unit of study is to develop the skills of comparative lawyers in effectively and critically assessing contemporary developments in the legal system of one of the world's wealthiest democracies.

After an overview of comparative law techniques, Japanese legal history and its contemporary legal system, classes in Kyoto explore issues of civil and criminal justice, politics and constitutionalism, government and the law, gender and law, and consumer law.

Classes in Tokyo then focus on business law, outlining Japan's economic policy and free trade agreements, before examining corporate governance, labour law, finance and investment law, arbitration and alternative dispute resolution, and legal practice opportunities.

For more information, visit:

- sydney.edu.au/law/offshore/kyoto_tokyo



Southeast Asia Field School

The Southeast Asia Field School introduces you to the legal systems of Southeast Asia, focusing on Indonesia and Malaysia – countries that have rich legal traditions and complex legal systems.

This unit of study covers various areas of law, including commercial law, human rights law, Islamic law, customary law and constitutional law, and examines the effects of colonialism on law.

It is taught with the cooperation of Gadjah Mada University in Yogyakarta, Indonesia, and ZICOLaw in Kuala Lumpur, Malaysia.

For more information, visit:

– sydney.edu.au/law/offshore/southeastasia

The Sydney Law School in Europe

The Sydney Law School in Europe program offers units of study in prestigious European locations. Our specialist academics and adjunct faculty members teach the units in conjunction with leading international lawyers or specialist law academics.

Each unit is taught intensively over four to five days, with assessment due some weeks afterwards. Past venues have included: Jesus College, Cambridge; Humboldt Law School, Berlin; and Stavanger University, Norway.

For more information, visit:

– sydney.edu.au/law/offshore/europe

Shanghai Winter School

The Shanghai Winter School is an intensive three-week introduction to Chinese law that allows you to study the laws and legal system of China while experiencing life there.

This unit of study is jointly offered by Sydney Law School and the East China University of Politics and Law with classes held on campus in Shanghai, China.

Lectures are delivered in English by Chinese professors, with academic staff from Sydney Law School supervising the unit. A representative of Sydney Law School will be in residence in Shanghai to oversee the classes and assist participants.

For more information, visit:

– sydney.edu.au/law/offshore/shanghai



Master of Laws

Graduate Diploma in Law

The University of Sydney's Master of Laws (LLM) is one of Australia's leading postgraduate coursework programs in law.

The LLM is a flexible and highly sought-after degree that caters specifically to the needs of the legal profession. As a law graduate, you may choose from the entire range of units of study offered through Sydney Law School's postgraduate coursework program, allowing you to tailor an LLM program that suits your academic and professional needs.

Our postgraduate coursework program is one of Australia's largest: we offer more than 120 units of study each year.

If you study full time it's possible to complete an LLM in one year by finishing eight units of study. If you study part time, you have a maximum of six years to complete your degree.

Complete your master's degree through semester-length units of study

The semester-length delivery mode allows you to attend class once a week for 12 to 13 weeks. Classes are generally held on a weeknight, from 6 to 8pm. Assessments vary, but generally include either written assignments or take-home or sit-down examinations.

Please note that not all units of study are available in this mode.

Complete your master's degree through intensive units of study

The intensive delivery mode is a popular and flexible way to fast track your degree. It condenses each unit of study into four to five full days. Units are taught either in block mode (over a single block of four to five full days in a row) or consecutive mode (over four to five full days spread over the semester, such as two days in one week and a further two days a fortnight later).

Please note that not all units of study are available in this mode.

Complete your master's in one area of study, or combine disciplines

Our master's degree enables you to choose from the entire range of postgraduate coursework units of study offered in any given year by Sydney Law School.

You may choose to select all eight units of study from one area of specialisation, such as international law or corporate, securities and finance law, or you may combine areas of study by selecting units from commercial law alongside some from climate and environmental law.

Complete a single unit of study to count towards an LLM or other degree

You do not have to commit to completing the entire LLM program straight away – you can just undertake a single unit of study. Later you might choose to continue your enrolment and progress with the LLM, or delay further study until another unit of interest is taught. As long as you complete the assessment for the unit, that unit can later count towards an award course, such as the Graduate Diploma in Law, LLM or another program.

Complete units of study in Europe, China, Japan, Nepal or Southeast Asia

As a Master of Laws student you may enrol in offshore units of study. These include units taught as part of the Sydney Law School in Europe program, and those taught as part of other programs including the Shanghai Winter School. Whether the unit is taught in London, Cambridge, Berlin, Shanghai, Tokyo or Nepal, each unit that you complete counts towards your LLM. Additional costs may be involved.

For more information, visit:

– sydney.edu.au/law

Complete units of study taught by external international and domestic experts

Units are taught by our own academic staff and visiting international and domestic experts from other institutions and the legal profession.

Complete the graduate diploma and upgrade to the master's degree

If you are not ready to commit to undertaking the LLM but have a law degree and an interest in studying our coursework units, you can start with a Graduate Diploma in Law (GradDipLaw), which consists of four units of study. On completion, and with approval, you may transfer to the master's degree, which requires a further four units of study.



“Sydney Law School’s international reputation for corporate and commercial law influenced my decision to enrol in the Master of Laws. It allows me to choose the units of study and organise the course to meet my professional needs.

“This course has improved my critical thinking skills by providing me with a chance to discuss and exchange ideas with other students from various backgrounds. Studying at Sydney has had a significant impact on my career.

“I have gained knowledge in new practice areas, which helps me to develop my professional goals.”

Weeraya Prompiriya
Master of Laws

Structure

Master of Laws (LLM)

- Credit points required to complete: 48 (eight units of study)
- The minimum course duration is one year for full-time candidates and two years for part-time candidates.

Graduate Diploma in Law (GradDipLaw)

- Credit points required to complete: 24 (four units of study)
- The minimum course duration for the GradDipLaw is six months for full-time candidates and one year for part-time candidates.
- If you hold a Diploma in Law (DipLaw) from the Legal Profession Admission Board of NSW, you are eligible to apply for this qualification and, with approval, transfer to complete the LLM.

Units of study

If you are enrolled in the Master of Laws (LLM) or the Graduate Diploma in Law (GradDipLaw), you can choose the prescribed number of units of study from the entire range of units offered through the Sydney Law School postgraduate coursework program. This means you can either specialise in one area or combine your interests in a number of fields.

For an up-to-date list of the units of study currently available through this program, visit:

- sydney.edu.au/courses



“The Sydney LLM allowed me to gain an in-depth understanding in a broad range of subjects. They are related to both the areas in which I practise day to day and others that I don’t get involved in regularly, to help me gain more knowledge and familiarity with them.

“While it may be challenging to juggle work and study (along with many other commitments that you may have), it is definitely a rewarding experience. It will give you more confidence in the workplace and is a worthwhile investment in your professional development.”

Tharani Dharmaraj

Master of Laws

Senior Associate, Baker McKenzie, Sydney

Admission requirements

To be eligible for entry to the Master of Laws, you need:

- a Bachelor of Laws (LLB) or Juris Doctor (JD) with a credit average or an equivalent qualification or
- completion of the requirements of the embedded graduate diploma with a credit average or equivalent qualification.

To be eligible for the graduate diploma you need:

- a Bachelor of Laws or Juris Doctor, or an equivalent qualification.

More information

- sydney.edu.au/courses/master-of-laws



“I chose Sydney Law School for its reputation as a leading international law school. I wanted to be surrounded by the best and brightest. As a corporate lawyer, it was important for me to be studying with other like-minded people, and on day one I experienced this.

“In my classes I am able to engage and collaborate with peers and teachers who are passionate about the law, actively working in the legal profession and experts in their chosen field. A recent career highlight was being shortlisted as a finalist in the 2017 *Lawyers Weekly* ‘30 Under 30’ awards for mergers and acquisitions.”

Mitchell Kelly
Master of Laws

Master of Business Law

Graduate Diploma in Business Law

Choose from the entire range of units of study offered through Sydney Law School's commercial law, corporate, securities and finance law, international business law, and Australian and international taxation programs, with this specialist qualification in business law and regulation.

This degree reflects the growing importance of legal literacy and business law expertise among non-lawyers working in business, finance, commercial and corporate environments. It also provides a qualification that builds on the completion of professional accountancy qualifications.

You can choose from up to 70 units of study in any given year – one of the largest choices of any master's by coursework program at Sydney Law School. If you choose to enrol in Master of Taxation units, you will need to complete the unit Introduction to Australian Business Tax and/or any other prerequisites.

Students who do not hold a law degree from a common law jurisdiction will be required to complete Legal Reasoning and the Common Law System.

Structure

Master of Business Law

- Credit points required to complete: 48 (eight units of study)

Graduate Diploma in Business Law

- Credit points required to complete: 24 (four units of study)

More information

- sydney.edu.au/courses/master-of-business-law



Master of Taxation

Graduate Diploma in Taxation

Sydney Law School is an international leader in tax education.

Our Tax Program is taught by academics and practitioners who are internationally recognised leaders in their fields, supported by renowned international visitors.

Our participants come from diverse backgrounds in Australia and overseas; they are recent graduates and established practitioners; and they come from professional firms and industry, the private sector and government.

We offer a comprehensive range of study options, with sophisticated coursework electives, opportunities for guided research projects and special programs tailored for domestic and international participants.

If you have had limited exposure to the detail of Australian tax law so far in your studies or career, we recommend you start your study with our unit of study Introduction to Australian Tax.

Units are taught either throughout the semester or over shorter periods in intensive format (see page 10).

Structure

Master of Taxation

- Credit points required to complete: 48 (eight units of study)
- Selected from the range of relevant units on offer.

Graduate Diploma in Taxation

- Credit points required to complete: 24 (four units of study)
- Selected from the range of relevant units on offer.

More information

- sydney.edu.au/courses/master-of-taxation



“I think Sydney Law School offers the best Master of Taxation program in Australia. There is a great variety of courses and topics to choose from.

“The courses are both academic and practical. One unit I took was taught by a professor from the University of Cambridge, while another unit engaged guest lecturers from the profession and the Australian Taxation Office.”

Jacky Wu
Master of Taxation

Master of International Law

Graduate Diploma in International Law

An acknowledged leader in the field of international law, Sydney Law School offers a unique program that focuses on core areas of international law with a variety of specialisations.

Our international law program prepares you for professional work and academic research in the fields of public international law and international policy by equipping you with skills and knowledge to negotiate the legal and policy issues affecting relations between states; between states and international organisations; and between states and individuals.

The Master of International Law also offers you the opportunity to complete an optional International Law Research Project, worth the equivalent of two units of study.

Structure

Master of International Law

- Credit points required to complete: 48 (eight units of study)
- You need to complete three core units: International Law I, International Law II and one approved International Studies unit, as well as five elective units chosen from the range of relevant units on offer.

Graduate Diploma in International Law

- Credit points required to complete: 24 (four units of study)
- You need to complete two core units, International Law I and International Law II, as well as two elective units chosen from the range of relevant units on offer.

More information

- sydney.edu.au/courses/master-of-international-law



Master of Health Law

Graduate Diploma in Health Law

Sydney Law School offers one of the nation's leading postgraduate programs in health and medical law.

The Master of Health Law is a flexible, specialist qualification providing wide-ranging interdisciplinary coverage of contemporary legal and social issues in healthcare.

The Graduate Diploma in Public Health Law provides a specialist qualification focusing on laws and legal strategies for protecting and promoting public health. Graduates of the diploma may apply to upgrade to the Master of Health Law. This program is ideal for health lawyers, health administrators, doctors, nurses and other health professionals.

Structure

Master of Health Law

- Credit points required to complete: 48 (eight units of study)
- You need to undertake three of the following four core units: Critical Issues in Public Health Law, Government Regulation, Health Policy and Ethics, Health Care and Professional Liability, and Information Rights in Health Care. You may then choose four to five electives from the range of relevant units on offer.
- Students without a law degree need to complete the unit Legal Reasoning and the Common Law System, or Introduction to Law for Health Professionals.

Graduate Diploma in Health Law

- Credit points required to complete: 24 (four units of study)
- This graduate diploma includes two core units: Health Care and Professional Liability, and Information Rights in Health Care. You may then choose two to three electives from the range of relevant units on offer.
- If you don't have a law degree, you will need to complete the unit Legal Reasoning and the Common Law System or Introduction to Law for Health Professionals.



“The Master of Health Law at Sydney Law School was uniquely interdisciplinary. It gave me the opportunity to collaborate with students from medical, healthcare, research and social science backgrounds. I benefited from the diverse insights of a peer group comprising different ages, interests and professional experience. You can choose from a fantastic range of specialised postgraduate degrees.”

Kate Hewson
Master of Health Law

More information

- sydney.edu.au/courses/master-of-health-law

Master of Environmental Law

Graduate Diploma in Environmental Law

This unique and innovative program involves study across the fields of science and law, and is at the forefront of contemporary issues in climate and environmental law.

Climate and environmental law form one of the most rapidly expanding areas of specialisation in the law. At Sydney Law School this expansion is reflected in the abundance and variety of units available in the study of this field.

The program features a wide range of options, including opportunities to undertake units offered through the Sydney Law School in Europe program and through other related disciplines.

The program is designed to meet the needs of both Australian environmental specialists and those from other countries. Non-lawyers working or wishing to work in the environmental field are welcome to enrol in the program, with the foundation unit Legal Reasoning and the Common Law System designed specifically to assist such students.

Structure

Master of Environmental Law

- Credit points required to complete: 48 (eight units of study)
- Completion of the core unit Environmental Law and Policy, and six to seven electives chosen from the range of relevant units on offer. Students without a law degree need to complete the unit Legal Reasoning and the Common Law System.

Graduate Diploma in Environmental Law

- Credit points required to complete: 24 (four units of study)
- Completion of the core unit Environmental Law and Policy, and two to three electives chosen from the range of relevant units on offer. If you do not have a law degree, you will need to complete the unit Legal Reasoning and the Common Law System.

More information

- sydney.edu.au/courses/master-of-environmental-law



Master of Administrative Law and Policy

Develop your understanding of the relationship between the law and analysis and implementation of public policy by examining the values inherent in administrative law and those of public administration, together with the practical aspects of applying the law.

This program offers the opportunity for public administrators specialising as lawyers or policy analysts to learn together within the disciplines of law, government and social policy. It also provides an understanding of public policy objectives and of appropriate methodological approaches to analysing the social and economic effects of reforms.

This degree is unique in terms of its content and delivery. Administered by Sydney Law School, it offers you an opportunity to complement your law studies with study through the University's Faculty of Arts and Social Sciences and our School of Education and Social Work.

Structure

- Credit points required to complete: 48 (eight units of study)
- Completion of three core units: Administrative Law, Public Policy, and Policy Making, Power and Politics (offered by the Department of Government and International Relations).
- If you don't have a law degree, you will also need to complete the unit Legal Reasoning and the Common Law System. You may choose all remaining units as electives.

More information

- sydney.edu.au/courses/master-of-administrative-law-and-policy

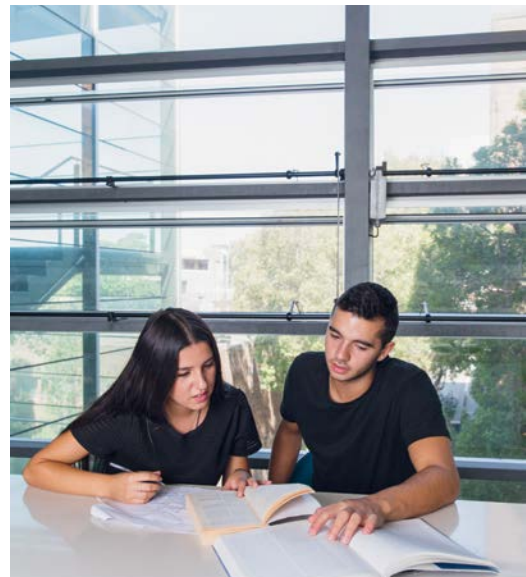

Master of Administrative Law and Policy

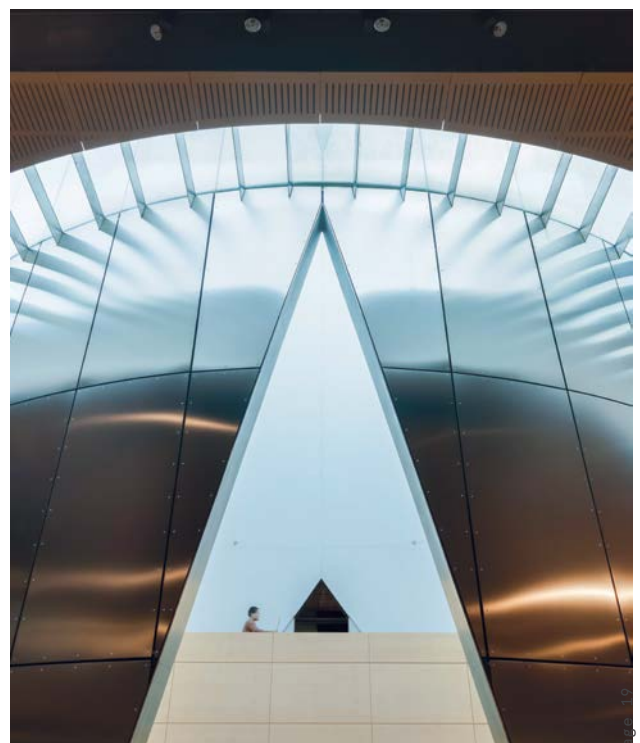

Page 110

Master of Criminology

Graduate Diploma in Criminology

Gain a critical understanding of criminology through a broad selection of interdisciplinary units delivered by some of Australia's leading criminologists.

Designed for anyone with an interest in crime, punishment and criminal justice, the program addresses contemporary questions about crime and control within theoretical and policy contexts, exploring crime in modern Australia and comparing it with a wide range of local and global community concerns. We welcome students from social sciences, research and social policy backgrounds.

You will study under Australia's experts in criminal law, criminal justice policy, juvenile and restorative justice, forensic psychology, crime and Aboriginal and Torres Strait Islander issues, international and comparative criminal justice and policing. This course recognises the importance of research, policy and applied learning.

We will equip you for work with public and private criminal justice and social welfare agencies with a focus on psychology and psychiatry, public policy, social research and legal practice.

Structure

Master of Criminology

- Credit points required to complete: 48 (eight units of study)
- The program includes three core units of study: Crime Research and Policy, Explaining Crime, and Criminal Liability (students with a law degree are exempt from Criminal Liability). You may then choose five to six electives. You may also seek permission to study two elective units offered either by Sydney Law School or by another faculty.

Graduate Diploma in Criminology

- Credit points required to complete: 24 (four units of study)
- The program includes two core units of study: Crime Research and Policy, and Explaining Crime. You may then choose two electives. You may also seek permission to take one elective unit offered either by the Sydney Law School or by another faculty.

More information

- sydney.edu.au/courses/master-of-criminology



"The Master of Criminology was a career change for me, and it has led to a PhD and academia. Through my master's dissertation I developed research skills that led to the PhD. Coming from a journalism background, this degree gave me the expertise I needed to write with confidence. It consolidated the industry knowledge I had gained from working in legal journalism, got me into teaching, and connected me to a range of institutions, so that coming to the end of my PhD I have an established network of experts to collaborate with."

Justin Ellis
Master of Criminology

Master of Jurisprudence

Graduate Diploma in Jurisprudence

One of Sydney Law School's key strengths, our Jurisprudence program provides a deep theoretical examination of the law, with a focus on its philosophical and sociological aspects.

The program explores the law's fundamental properties and its operation across history and different cultures.

Structure

Master of Jurisprudence

- Credit points required to complete: 48 (eight units of study)
- Includes the core unit Jurisprudence Research Project, as well as electives chosen from the range of relevant units on offer. You may choose to enrol in one non-law elective offered by the Faculty of Arts and Social Sciences.

Graduate Diploma in Jurisprudence

- Credit points required to complete: 24 (four units of study)

More information

- sydney.edu.au/courses/master-of-jurisprudence



Master of Labour Law and Relations

Sydney Law School offers a rare and flexible program in employment and labour law that allows law graduates to pursue specific units in labour law, employment law, discrimination law and dispute resolution.

The Master of Labour Law and Relations is a sought-after qualification for people with or without a law degree that merges the expertise of Sydney Law School with the discipline of Work and Organisational Studies (part of the University of Sydney Business School) and the Department of Political Economy.

If you are a lawyer or other professional working in the human resources field in government, business, industry or private practice, you will find this interdisciplinary master's degree an invaluable professional training experience.

Structure

- Credit points required to complete: 48 (eight units of study)
- The Master of Labour Law and Relations requires completion of two compulsory units of study: Labour Law and Industrial Relations Policy.
- Students without a law degree need to complete the unit of study Legal Reasoning and the Common Law System, and at least three units from the list of core units.
- Students with a law degree need to complete at least four units from the list of core units, in addition to the two compulsory units.
- All students need to complete at least 24 (up to 42) credit points from Sydney Law School, chosen from the range of units on offer.

More information

- sydney.edu.au/courses/master-of-labour-law-and-relations



Continuing professional development

We offer a range of flexible options to meet your requirements, from semester-length and intensive units of study, with or without assessment, to local and overseas lectures, seminars and conferences.

Semester-length units are taught one evening a week, from 6 to 8pm, for 13 weeks. Intensive units are taught over four or five full days, from 9am to 5pm (these days might be in a single block or spread over the semester).

Single-unit study without assessment

This study option allows you to attend lectures, receive reading materials and access the unit's online e-learning website. You do not need to undertake assignments or examinations. You will not receive a formal University of Sydney grade, academic transcript or credit towards future award courses.

To find out more, please visit:

- sydney.edu.au/law/cpd/your-options/study-without-assessment.shtml

For more information, please email:
law.events@sydney.edu.au

Single-unit study with assessment

If you are seeking accreditation towards a degree (for which you need to complete formal assessment tasks), then you should apply for single-unit study with assessment.

If you successfully complete the units of study and their assessments, you may count up to 12 credit points (two units of study) of the relevant units towards your full degree if you subsequently enrol in that degree.

To find out more, please visit:

- sydney.edu.au/law/cpd/your-options/study-with-assessment.shtml

For more information, please email:
law.postgraduate@sydney.edu.au

Research

At the University of Sydney we are tripling our investment in research by 2020 to change the way we think about the world and how we live and work in it.

We are one of the world's top research universities and a member of Australia's prestigious Group of Eight network and the Association of Pacific Rim Universities. This association partners us with other institutions that excel in research, including Stanford, UCLA, Shanghai Jiao Tong University and the University of Hong Kong.

Our research is shaped by the big picture. We look at real-world problems from all angles, combining the expertise and talents of scholars from many disciplines.

This collaborative spirit drives our interdisciplinary research centres, including several dedicated to deepening our understanding of China and Southeast Asia, and increasing Australia's engagement in these regions. We're home to more than 90 research and teaching centres and we have a proud track record of excellence. The Australian Government ranked all of our research at world standard or above in its latest Excellence in Research for Australia ratings.

Find out more about our current research:

– sydney.edu.au/research

Our research degrees

Embarking on a research degree at Sydney is an opportunity to work alongside some of the world's brightest and most accomplished academics. We offer exceptional facilities – the latest innovative technology across the physical, medical, life and engineering sciences, the humanities and social sciences.

We are investing in major new facilities to support collaboration and partnerships with researchers from diverse disciplines who are tackling society's most challenging problems.

We have the drive to challenge traditional ways of thinking. You will have the support you need to contribute to research that makes a meaningful, real-world impact and changes lives.

We offer several higher degrees by research – the Doctor of Philosophy (PhD) is the highest qualification that you can attain in Australia.

Learn more about our research degrees:

– sydney.edu.au/study/find-a-course/postgraduate-research.html

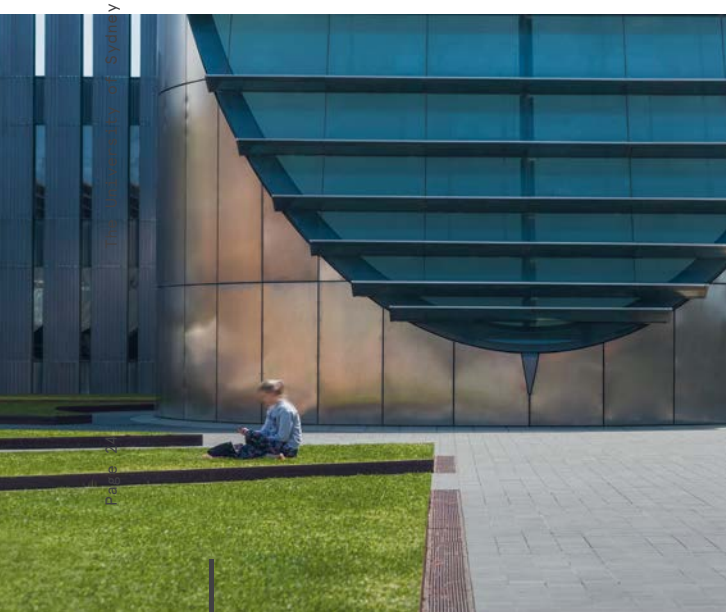

Our research programs in law

Sydney Law School offers research programs that equip you for a career in advanced research, policy development, public service, tertiary teaching or professional leadership. Our programs enable you to develop sophisticated skills in research and analysis honed through extensive work on a topic of your choice.

Doctor of Philosophy

The PhD involves successful completion of a thesis of 80,000 words that must make a substantially original contribution to its subject. It involves a process of supervised research and writing on an approved topic. Candidates also need to undertake the units of study Legal Research 1, 2 and 3.

Master of Laws by research

The Master of Laws (LLM) is awarded on the basis of a supervised thesis of 50,000 words that needs to make a substantial contribution to its field. Candidates also undertake the unit Legal Research 1.

Master of Criminology by research

This degree is awarded on the basis of a supervised thesis of 50,000 words that must make a substantial contribution to its field. You may wish to explore aspects of criminology, drug policy and the law, gender and race relations, youth and crime, policing in society and other social and cultural issues. You will also need to undertake the unit Legal Research 1.

Sydney Law School offers you the opportunity to pursue your interests in our 21 specialist research themes:

- Asian and Islamic law
- children, youth, and families
- citizenship, migration and refugees
- commercial and international commercial law
- constitutional and administrative law
- corporate, securities and finance
- criminal law, justice and criminology
- energy and emerging technologies
- environmental law and climate change
- gender, sexuality and the law
- health law, governance and ethics
- human rights and development
- Indigenous people and the law
- intellectual property, media and privacy law
- international law
- justice, legal process and the profession
- jurisprudence and legal theory
- labour, employment and anti-discrimination law
- legal history
- private law: tort, contracts, equity and property
- taxation.

Research experience in law

Undertaking postgraduate research in law is both rewarding and challenging. As a prospective student, there are several questions you need to ask yourself before beginning the application process.

Topic selection and project design

What topic will sustain your interest and motivation for the duration of your research degree? What skills are demanded by your specific project? Do you need to fill gaps in your knowledge or skills base in order to undertake the proposed project?

Supervisor selection

Does your proposed supervisor have strong interest and expertise in your chosen field of research? Do you feel you can work constructively with your proposed supervisor?

Study/life balance

Trying to balance the demands of postgraduate research with other potentially conflicting demands – such as work, financial and family responsibilities – can be challenging.

Some of the challenges you might face as a postgraduate research student include:

- maintaining motivation and momentum in your research work
- managing feelings of being overwhelmed, stressed and/or isolated by the demands of your research
- developing key skills required in your research – one of the most important being the skill of writing a thesis, which is likely to be a much more substantial writing exercise than any you have previously undertaken.

It can be helpful to think of the postgraduate research experience as a process in which your proposed thesis is likely to evolve and be shaped and reshaped throughout your candidature as you develop into an expert in your chosen field.

You may wish to discuss these issues in advance with your prospective supervisor.

For more information about the postgraduate research experience in law at Sydney Law School, please visit:

- sydney.edu.au/law/fstudent/research/research_experience.shtml





Admission to a research degree

Entry requirements

Before applying to undertake a program of postgraduate research you need to ensure you are academically qualified. If not, you should instead consider taking a postgraduate coursework program. There are three main entry requirements for admission to a postgraduate research degree:

- academic qualifications
- research and publication experience
- suitability of the proposed course of study and research.

Academic qualifications

The minimum academic qualifications required for entry to a postgraduate research degree are:

Doctor of Philosophy

A master's degree, or a bachelor's degree with first-class or second-class honours from the University of Sydney (or equivalent qualification).

Master of Laws by research

A Bachelor of Laws with first-class or second-class honours from the University of Sydney (or equivalent qualification).

Master of Criminology by research

A bachelor's degree with first-class or second-class honours from the University of Sydney (or equivalent qualification).

Please note that you may be admitted to a research program based on qualifications that the Postgraduate Research Committee considers equivalent to an honours degree.

Research and publication experience

You need to show satisfactory evidence of research training and of your ability to complete the proposed research program within the minimum period of time. You may demonstrate this through the successful completion of a sustained piece of research for an earlier degree program, sustained research in a professional capacity (for example, as a research assistant on a successfully completed project), scholarly publications or experience in some other research-related endeavour.

Suitability of the proposed study or research

Your proposal needs to be:

- suitable in scope and standard for the program in which you wish to enrol
- one that you are competent to undertake
- one for which supervision and facilities can be properly provided.

For more information about how to apply for a research degree, see page 31.

Centres and institutes

Sydney Law School has eight research centres and institutes that inform and reflect our postgraduate coursework and research programs. They provide a conduit for specialist knowledge for all audiences, including the academic and professional community as well as the general public.

Australian Centre for Climate and Environmental Law

The Australian Centre for Climate and Environmental Law is an internationally recognised centre at the forefront of this field of law. The centre aims to encourage, promote and support innovative and outstanding scholarship through teaching, research, consultancy and public interest advocacy.

– sydney.edu.au/law/accel

Centre for Asian and Pacific Law

The Centre for Asian and Pacific Law is a leading centre for the teaching and research of law and legal systems in Asia and the Pacific. Its members have legal expertise in a wide variety of Asian and Pacific jurisdictions, particularly China, Japan, Indonesia and Malaysia.

– sydney.edu.au/law/caplus

Sydney Health Law

This centre builds on the excellence in health law research and teaching within Sydney Law School. Academic staff affiliated with the centre teach in the Law School's extensive coursework offerings in health law.

– sydney.edu.au/law/health

Sydney Institute of Criminology

The Sydney Institute of Criminology is an internationally recognised centre of criminological expertise. It publishes the journal *Current Issues in Criminal Justice* and a series of books on the topics of crime and criminal justice.

– sydney.edu.au/law/criminology





Julius Stone Institute of Jurisprudence

The Julius Stone Institute of Jurisprudence was established in 1999 with the assistance of funds from our alumni and friends; in particular those who were students, colleagues or friends of Professor Julius Stone. The institute recognises and celebrates Professor Stone's outstanding contribution to legal scholarship, and serves as a focus for theoretical scholarship in Australia, continuing the Law School's strong leadership in this field.

– sydney.edu.au/law/jurisprudence

Ross Parsons Centre for Commercial, Corporate and Taxation Law

The Ross Parsons Centre undertakes, promotes and supports innovative and important scholarship, including teaching, research, consultancy and advocacy, in all areas of commercial, corporate and taxation law. The centre delivers undergraduate and postgraduate courses, conferences and seminars, sponsors visits from international and Australian academics, encourages research and builds links with other institutions with similar goals.

– sydney.edu.au/law/parsons

Sydney Centre for International Law

The Sydney Centre for International Law is a centre of excellence in research, public policy and teaching in international law. Since its establishment in 2003, the centre has emerged as a hub of international legal thought and debate in the Asia-Pacific region, building on Sydney Law School's long history of innovation in the international legal field.

– sydney.edu.au/law/scil

Constitutional Reform Unit

Established in 2011, the Constitutional Reform Unit is an interdisciplinary body that draws on expertise across the University. It provides research and analysis on proposals for constitutional reform in Australia, at both federal and state levels. It provides commentary on current controversies in its blog, 'Constitutional Critique'.

– sydney.edu.au/law/cru

How to apply

Domestic coursework applicants

For detailed information on how to apply, including the latest timetable and unit descriptions, visit:

- sydney.edu.au/courses

Admission requirements

Master of Laws

- a Bachelor of Laws or Juris Doctor with a minimum credit average from the University of Sydney or an equivalent qualification; or
- completion of the requirements of the Graduate Diploma in Law with a minimum credit average or an equivalent qualification.

Graduate Diploma in Law

- a Bachelor of Laws or Juris Doctor from the University of Sydney or an equivalent qualification.

Specialist Law Master's Degrees

- a bachelor's degree with a minimum credit average from the University of Sydney or an equivalent qualification; or
- a bachelor's degree from the University of Sydney or an equivalent qualification and evidence of two years of relevant professional experience; or
- completion of the requirements of an embedded Graduate Diploma with a minimum credit average or an equivalent qualification.

Specialist Graduate Diplomas

- a bachelor's degree from the University of Sydney, or an equivalent qualification.

Master of Jurisprudence

- a bachelor's degree with a minimum credit average from the University of Sydney or an equivalent qualification; or
- completion of the requirements of the Graduate Diploma in Jurisprudence with a minimum credit average or an equivalent qualification.

Graduate Diploma in Jurisprudence

- a bachelor's degree from the University of Sydney or an equivalent qualification.

Closing dates – coursework applications

- 31 January 2018 for Semester 1 courses commencing in February 2018
- 30 June 2018 for Semester 2 courses commencing in July 2018

We strongly encourage you to apply as early as possible, as offers are made on a rolling basis.

Applications for enrolment in the University of Sydney Law School intensive units will be accepted all year round from eligible applicants.

Submit your application online at:

- sydney.edu.au/courses

Documents to supply

- Official transcripts of all academic qualifications you hold. The transcripts need to contain all final semester grades, grading information and course completion/conferral date(s). If the transcripts are not in English, please provide official translated transcripts in addition to the original transcripts.
- Proof of Australian or New Zealand citizenship or of Australian permanent resident status (copies of original documents need to be certified by a Justice of the Peace or a Sydney Law School staff member).
- Statement of relevant experience.
- English language proficiency test result (if applicable).

International coursework applicants

For detailed information on how to apply, including the latest timetable and unit descriptions, visit:

- sydney.edu.au/courses

Closing dates

- 31 January 2018 for Semester 1 courses commencing in February 2018
- 30 June 2018 for Semester 2 courses commencing in July 2018

We strongly encourage you to apply as early as possible, as offers are made on a rolling basis. These deadlines set the minimum time required for us to consider and process your application properly. However, late applications may be considered.

If you have undertaken your previous studies in a language other than English, you will need to demonstrate English language proficiency before admission.

Domestic and international research applicants

There are two stages involved in applying to a research program.

Stage 1: Expression of Interest (pre-application)

Before making a formal application, you need to complete an Expression of Interest form detailing your area of intended research, academic qualifications, professional or other qualifications, original research activities and publications, and any other information relevant to the application. The form is available at:

– sydney.edu.au/courses

You need to submit your Expression of Interest at least three months before the official closing date. If your Expression of Interest is accepted, you will be advised of your eligibility to proceed to making a formal application (Stage 2).

Stage 2: Formal application for admission

Complete the Application for Admission form available at:

– sydney.edu.au/courses

Closing dates – research applications (including course transfers)

We need to receive your application by:

- 31 December for Research Period 2 (begins 1 March)
- 30 April for Research Period 3 (begins 1 July).

We accept applications at any time up to the prescribed due date. If your application is not assessed in time, we will automatically consider it for the next possible course commencement date. Submit your application online at:

– sydney.edu.au/courses

Supporting documents

For further details, visit our website:

– sydney.edu.au/courses

Research scholarships

Sydney Law School Research Scholarships:

– sydney.edu.au/law/scholarships

Research Office

Level 5, Jane Foss Russell Building
The University of Sydney NSW 2006
+61 2 8627 8112
+61 2 8627 8485

– sydney.edu.au/research_support

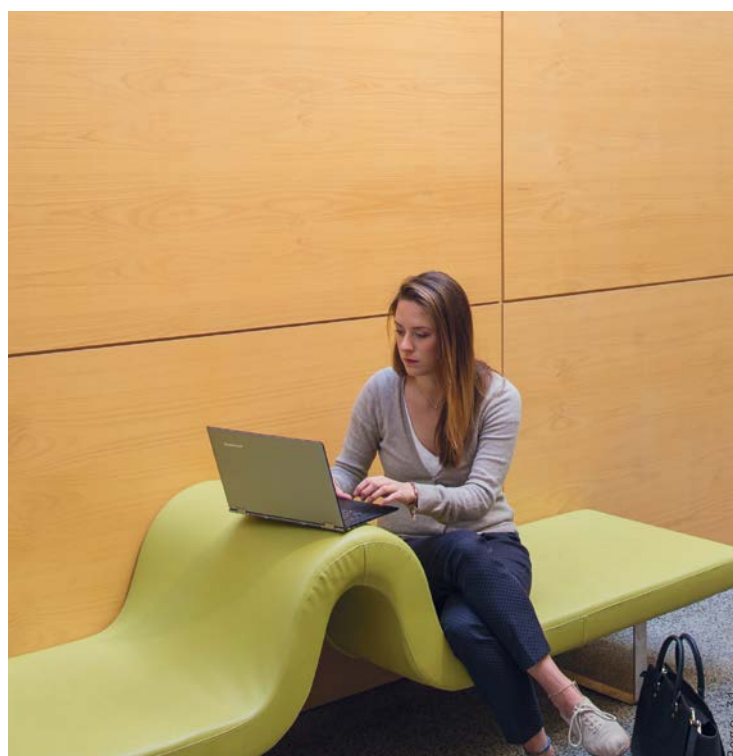

Fees and costs

Postgraduate

Domestic students

Most domestic postgraduate students study in a fee-paying place, however, a limited number of Commonwealth supported places (CSPs) may be available for some courses, on a competitive basis. Refer to your specific course in sydney.edu.au/courses to determine if it offers CSPs.

Fee-paying students

The University calculates the tuition fees for single postgraduate coursework degrees based on an annual course fee that is subject to increase each year. Fees are based on a full-time student enrolment load of 24 credit points per semester, or 48 credit points (eight units of study) per year (1.0 EFTSL). If your study load for the year is more or less than 1.0 EFTSL your tuition fee or student contribution amount will differ. Check the tuition fees for your specific course at sydney.edu.au/courses

The Australian Government does not subsidise fee-paying places. However, the government-funded loan program FEE-HELP is available to eligible domestic postgraduate coursework students to assist in paying your tuition fees. For more information, visit www.studyassist.gov.au

Research Training Program

The government-funded Research Training Program provides funding for eligible domestic Higher Degree by Research candidates to cover the cost of their tuition fees for the duration of an accredited course. This can be up to four years full-time equivalent study for a doctorate by research and two years of full-time equivalent study for a master's degree by research. To find out more, visit sydney.edu.au/rtp

International students

The University calculates the tuition fees for postgraduate degrees based on an annual course fee that is subject to an increase each year. Tuition fees vary between courses and the calendar year that you undertake study. Fees are based on a full-time student enrolment load of 24 credit points per semester, or 48 credit points (eight units of study) per year (1.0 EFTSL). If your study load for the year is more or less than 1.0 EFTSL your tuition fee will differ.

Annual review

Tuition fees are subject to annual review by the University and will increase each year, effective at the start of each calendar year.

Other costs to consider

- additional course costs, such as course-specific materials and textbooks, tools, protective clothing, and equipment. For more information, visit your faculty's website: sydney.edu.au/faculties
- the Student Services and Amenities (SSA) fee: sydney.edu.au/ssa-fee
- living expenses such as food and rent: sydney.edu.au/study/living-costs

These costs are specific to international students:

- your first semester fee as a deposit
- health insurance through the Overseas Student Health Cover (OSHC) scheme; an Australian Government requirement for student visa holders: sydney.edu.au/pg-int-health
- an Application Processing Fee (unless you are eligible for a waiver): sydney.edu.au/study/tuition-fees
- education expenses for students' children: schools.nsw.edu.au/international

Method of payment

There are several ways you can pay the fees that apply to your study. Please note that a surcharge of 0.8 percent will apply for payments made by Visa or MasterCard. The surcharge is subject to review and may change. Information about payment methods and the surcharge is explained at: sydney.edu.au/study/paying-your-fees

Important dates

26 August 2017

Open Day

11 October 2017

Postgraduate Information Evening

5 March 2018

Semester One begins

Mid May 2018

Postgraduate Information Evening

30 July 2018

Semester Two begins

This guide provides the key information you need to apply for a postgraduate degree in law, but the next step is up to you.

To learn more, come and see us on Open Day, attend one of our postgraduate information sessions, call our helpline or visit our website.

sydney.edu.au/postgraduate
sydney.edu.au/law